

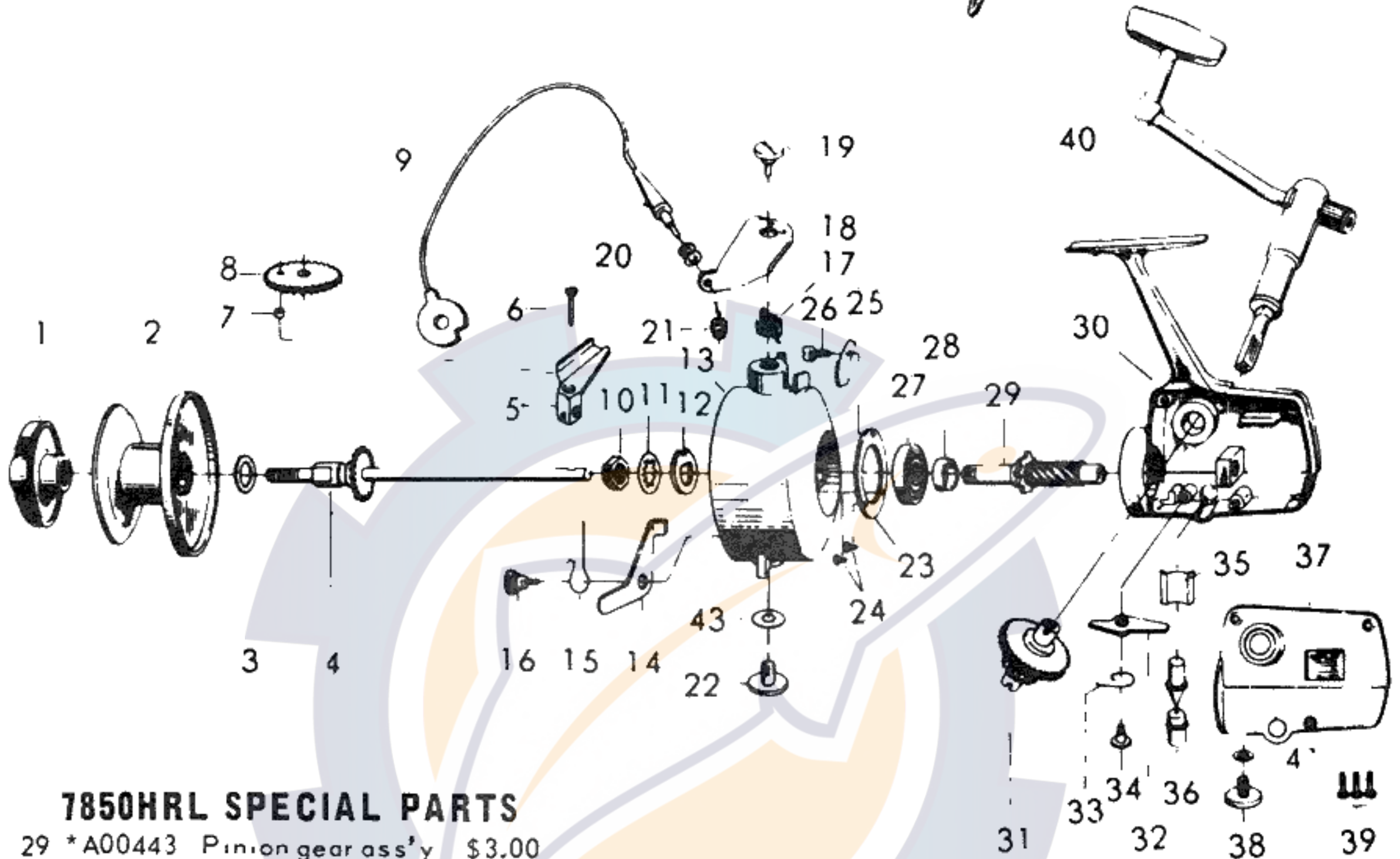

DAIWA
CORPORATION CALIF.

7850RL
7850HRL

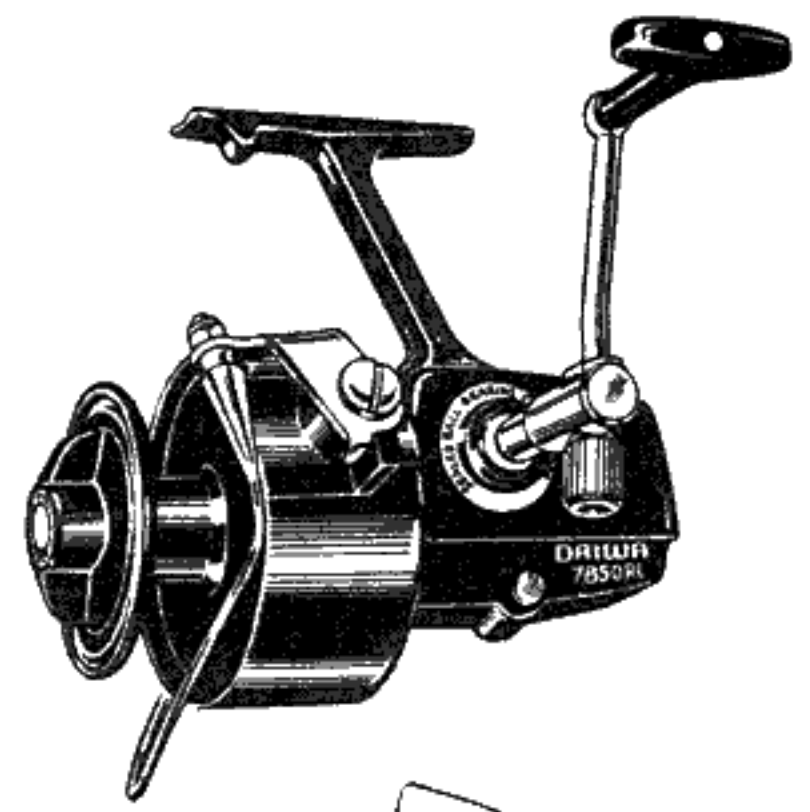

7850HRL SPECIAL PARTS

- 29 *A00443 Pinion gear ass'y \$3.00
- 31 *A00444 Master gear ass'y 3.75

LINE CAPACITY: 300 YDS., 20 LB. TEST

Key No.	Stock No.	Parts Name	Price	Key No.	Stock No.	Parts Name	Price
1	*A00437	Drag knob assembly	\$ 1.00	23	6338	Ball bearing retain. washer	\$.30
2	*A00438	Spool assembly	3.50	24	35122	Ball bearing retaining washer screw	.15
3	*37265-3	Spool washer	.15	25	1538	Cushion spring	.20
4	*A00143	Main shaft assembly	1.35	26	3591	Lever knock	.15
5	4819	Oscillating slider	.50	27	6339	Ball bearing	3.00
6	35121	Oscillating slider screw	.15	28	5012	Pinion gear shaft collar	.50
7	5011	Oscillating bull gear collar	.20	29	A0031	Pinion gear assembly	3.00
8	*A00440	Oscillating bull gear ass'y.	.50	30	*A00608	Main body assembly	3.75
9	*A00441	Bail arm assembly	2.00	31	A0032	Master gear assembly	3.75
10	3446	Rotor nut	.20	32	*1119a	Anti-reverse claw	.30
11	1617a	Rotor washer	.20	33	1498	Anti-reverse claw spring	.15
12	37139	Rotor retaining washer	.15	34	3672	Anti-reverse claw screw	.20
13	*A00442	Rotor assembly	2.50	35	1537	Anti-reverse lever spring	.15
14	5730a	Bail arm stopper	.50	36	5421	Anti-reverse lever	.95
15	1499	Bail arm stopper spring	.15	37	*A00445	Side plate assembly	.75
16	3674	Bail arm stopper screw	.15	38	3592	Handle retaining screw	.50
17	1496	Bail arm spring	.15	39	35137	Side plate screw (3 pcs.)	.20
18	2322	Bail arm cam A	.75	40	*A0033	Handle assembly	4.00
19	3656	Bail arm cam A screw	.50	41	37183b	Handle washer	.15
20	2515	Bail arm roller	.50	42	37188	Bail arm washer	.15
21	3485	Bail arm nut	.50				
22	36100	Bail arm cam B screw	.50				

* THESE ARE MODIFIED PARTS

ALWAYS SPECIFY MODEL NO , KEY NO & STOCK NO WHEN ORDERING PARTS
PLEASE ENCLOSE CORRECT AMOUNT FOR PART'S PRICE WHEN ORDERING